

Building Technology and Design

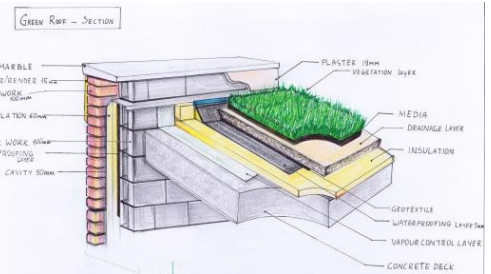

This course is relevant to students wishing to pursue a career in Architectural Technology / Building Design/ Building Management. Preparation of students for suitability tests, model making and the preparation of portfolios for Architecture Courses are strong features of the course.

This course is designed to

Develop the necessary skills and techniques of Computer Aided Draughting, Building Construction and Design.

Course Content

Computer Aided Draughting (2D)	Design Skills	Communications
Work Experience	Architectural Drawing	Building Construction
Mathematics	Safety & Health at Work	Renewable Energy Systems

Career Prospects Students who qualify in this area can pursue further study & a career in:

Timber Product Technology	Building Management	Product design
Architectural Technology	Civil Engineering	Architecture
Quantity Surveying	Building Services	Other Construction related courses

Certification

QQI Level 5 Award in Building Technology and Design 5M1940.

Entry Requirements

- Leaving Certificate, Leaving Certificate Applied, or equivalent
- Interview
- Mature applicants welcome



How the Course is taught

- This is a practical course where learning takes place primarily in workshops and drawing rooms.
- We use a Learn-by-Doing approach to make the learning experience more realistic and enjoyable.
- We provide learning supports that are tailored to meet the needs of individual learners.

Course/Programme Co-ordinator. Gavin White

Apply Online at www.sligocfe.ie

Email gavinwhite@msletb.ie or

Phone 071-9145480 for further info or with any questions you may have.

